

The Digital Dreams Series units are RS-485 based HF Ballast Dimming and Relay switching devices designed to be mounted in electrical switchboards concealed in side the wall or similar enclosures. For ease of installation, they are also DIN rail mounted, measuring 4 DIN modules wide. The independent unit is programmed to function as stand alone unit. Alternatively, units can be programmed via a PC along with Gateway. The unit is consisting of Power Supply, Control section and Driver devices. The unit is self powered with single phase supply used locally. LED Indicators inside the unit shows the status of CPU Unit and Load Status.

IR Remote can control ON and OFF along with HF Ballast Dimming facilities and permits all channels to be controlled locally without any RS-485 network communication.

The RS-485 Bus & Inputs are electrically isolated.

Power recovery puts all the loads in OFF position.

AUTOMATION MODULE : DL 8I 4ODC 4DD HF Ballast dimming / relay Module

The DL 8I4ODC4DD is an 8 channel controller with,

- 8 input for buttons
- 4 output for HF Ballast Dimming application with Dry Contact for Load Isolation &
- 4 output for ON / OFF application

Input : 8 isolated input with isolated dry contacts for command to individual load to be controlled.

Dimming : 4 channels are for dimmed using 1-10V DC technology. Each channel can handle maximum Four such Ballast. Each such channel is provided with an Isolation ON/OFF by Dry Contact.

ON / OFF : 4 independent relay contacts, suitable for most types of switched loads up to 2A rating.

Technical data :

Inputs :

- Supply Control Inputs - 230V \pm 10% 50Hz Single Phase – Phase, Neutral and Earth
- RS485 Network termination
- 8 input buttons for each load
- IR Port

Outputs :

Dimming : 1 – 10 V DC out put

Relay : 7 A

Operating Condition : 0° to 40°C ambient temperature, 0% to 95% RH non condensing

8 Bit with 100 Steps resolution

Dimmer Module Power Conditioning Compliance

- Over voltage protection
- Surge protection Enclosure
- Brownout/Sag protection ABS DIN Rail enclosure (4 unit)
- Spike protection
- Soft start

Dimensions : L 280 mm X H 120 mm X D 75 mm

Module dimension

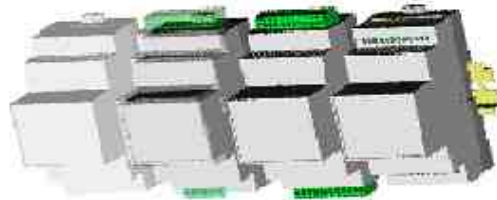
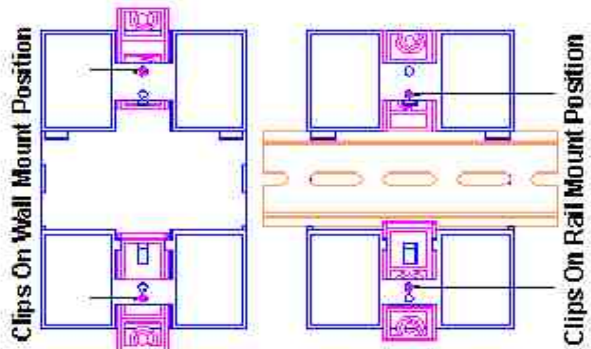
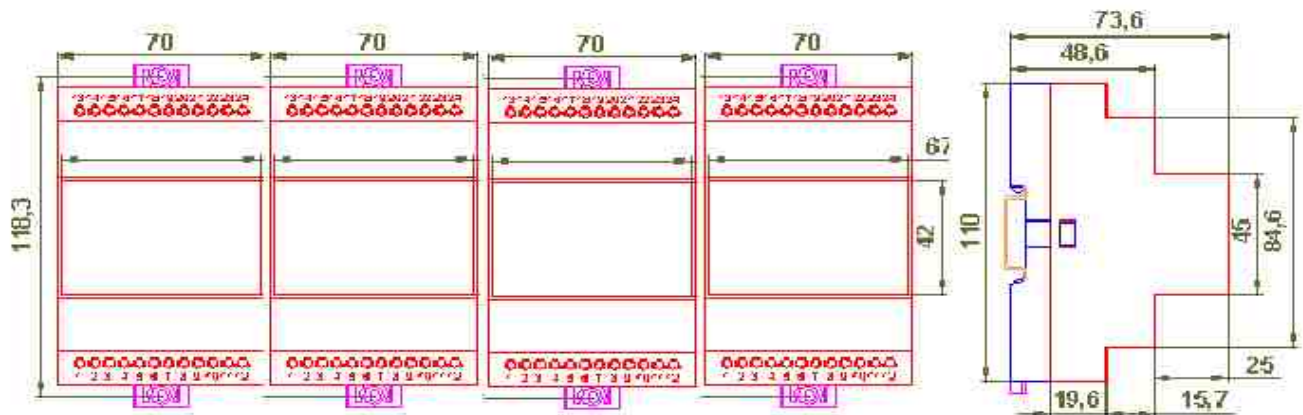

Dimensions - DIN rail type

w = 280 mm, h 120 mm, d = 75 mm



M/S. NCC Telecom Pvt. Ltd. - India.

info@ncc.co.in

www.ncc.co.in

Specifications subject to change without notice.
All rights reserved. Warranty is limited for our products only and not for other integrated items or failure due to integration.

for further information contact: